

RAGLAN ARTS WEEKEND

Anniversary Weekend
Saturday 30, Sunday 31 January
& Monday 1 February 2016

Artists' Open Studios & Exhibition at
the Old School Arts Centre 10am – 3pm

These Studios open until 5pm ☺
Look out for the pink & turquoise
flags to find the Open Studios! 🚩

📌 facebook.com/raglanart



Raglan Old School Arts Centre
5 Stewart Street
Open for exhibitions and events.

07 825 0023 raglanartscentre.co.nz

1. AARON KEREOPA ☺

Carved surfboards
📍 4338 Main Rd
☎ 021 183 5891

2. AILENE CUTHBERTSON

Digital art and ceramic sculpture
📍 Old School Arts Centre
✉ ailene@oldmountainart.com
🌐 oldmountainart.com

3. BIG MONSTERS - HAYLEY HAMILTON & KARLA STEVENSON

Ceramic & mixed media
📍 58 Wallis St
☎ 825 0444
✉ ibigmonsters@xtra.co.nz
📌 facebook.com/themonsterco

4. CHRIS MEEK ☺

Panel & Paint
📍 21 Cross St
☎ 027 328 1036
✉ info@chrismEEK.co.nz
🌐 chrismEEK.co.nz

5. CLAUDIA GRUTKE ☺

Painting
📍 42B Upper Wainui Rd
☎ 825 8082 or 022 1776378
✉ claudia.grutke@gmail.com
🌐 claudiagrutke.com

6. CONTAINER LOAD ☺

Photography
📍 21 Cross St
☎ 021 846 786
🌐 annepaarphotography.com, karinvantil.com

7. DENISE FORT ☺

Black & white drawings on canvas, wood,
handmade paper, lampshades and crockery
📍 7 Wainui Rd
☎ 021 075 2823
🌐 denisefort.co

8. HEARTBEADS – Peter Hohenberger ☺

Hot Glass, Lampwork, Beadmaking
📍 78D Greenslade Rd
☎ 825 0992
🌐 heartbeads.co.nz

9. JEAN CARBON

Fabric / Fashion
📍 CBarn 492 Wainui Rd
☎ 825 8877 or 027 204 6820
✉ jean@cbon.co.nz
🌐 cbon.co.nz

10. JENNY RHODES

Variety of mediums
📍 21 Government Rd
☎ 021 216 2063

11. JODI COLLINS (Ahoy Creative Crew) ☺

Painting, clay work, jewellery, upcycling, crafty
creations
📍 11 Bankart St
☎ 027 424 7277
📌 facebook.com/HelloGalleryRaglan

12. KEN THOMAS

Painter
📍 Rock-it, 248 Wainui Rd
☎ 825 7038
🌐 art@kenthomas.info
📌 facebook.com/KenThomasRaglan

13. LOIS BROOKS

Acrylic Paintings
📍 27 Government Rd
☎ 825 0252
✉ blois1257@gmail.com

14. MATAPIHI ART - ARTIST RUN GALLERY

Jette Jespersen, Yann Bordier, Rob Sykes ☺
Paintings, prints, hand fabricated copper/bronze,
gemstone & silver jewellery. Driftwood sculptures,
carvings + more
📍 34 Bow St
☎ 825 6515 or 027 245 2115
📌 facebook.com/pages/Matapihi-Art-Gallery
🌐 matapihiartgallery.com

15. MEGAN HOCKLY

Acrylic & mixed media
📍 21 Cross St
☎ 022 134 5607
✉ meganhockly@gmail.com
📌 facebook.com/hocklyart

16. MIRANDA CAIRD ☺

Acrylic on canvas & merchandise.
📍 25A Calvert Rd, Whale Bay
☎ 825 0367
🌐 artinnewzealand.com - Merchandise
🌐 j.caIRD.vc.net.nz - Paintings

17. PALM PRINTS STUDIO ☺

Painting, photography & drawing
Jane Galloway, Stuart Mackenzie & Julian Godfrey
📍 23 Nihinihi Ave
☎ 825 0083
🌐 palmprints.co.nz

18. RAGLAN COMMUNITY CLAY SHED

Clay
📍 Behind the Old School Arts Centre
☎ 825 0023
🌐 raglanartscentre.co.nz

19. RAGLAN PHOTO GALLERY ☺

Photography
📍 53 Wainui Rd
☎ 021 2926 823
✉ jwanmilek@hotmail.com

20. RICHARD GEMMELL

Photography
📍 Old School Arts Centre
☎ 825 7974
✉ richard.gemmell@hotmail.com

21. RICK YOUMANS ☺

Oil on canvas & watercolour on paper
📍 106B Greenslade Rd
☎ 021 022 444 71
✉ rick@youmanscapsule.com
🌐 rickyoumans.com

22. RO FAWCETT SMITH

Painting
📍 Old School Arts Centre
☎ 0274 847 985
✉ smithandfawcett@xtra.co.nz

23. SAM MATHERS

Acrylic, mixed media and screen prints
📍 536 Wainui Rd
☎ 0273 800 177
📌 facebook.com/SamMathersArtist
🌐 sammathers.com

24. SIMON TE WHEORO ☺

Ta Moko, painting and sculpture
📍 4338 Main Rd
☎ 825 0244 or 0211 744 629
🌐 toihauauru.com

25. THE CREATIVE WORKSHOP

Painting, jewellery & ceramic sculpture
📍 Old School Arts Centre
☎ 825 5700
✉ karron.campbell@yahoo.co.nz

26. TINA WESSLING ☺

Paintings/ Mixed Media
📍 58 Wallis St
☎ 0221 10 6470 or 825 0086
✉ tinaraglan@gmail.com
📌 facebook.com/tina.wessling.art

27. YANIV JANSON ☺

Acrylic on Canvas
📍 Old School Arts Centre
☎ 027 288 1949
✉ yaniv@egl.ac.nz
🌐 yanivjanson.com

EXHIBITION & SILENT AUCTION

Sat 16 Jan - Mon 1 Feb

Old School Arts Centre
5 Stewart Street
Exhibition Open 10am – 3pm daily

Begin your arts weekend by visiting
the exhibition which features a piece of
artwork from all participating artists.

Plan your studio visits and bid on your
favourite piece of art in the silent auction.

BOW ST DEPOT

Is proud to support Raglan Artists.
DISCOUNT of 10% with this brochure
at the Bow St Depot Raglan.

2 Bow St, Raglan (07) 825 0976
bowstreetdepot.co.nz 📌

During Raglan Arts Weekend Jan 30-31-1 Feb 2016

Savour fine food, beverages
and explore the arts

Little FOOD FEST

Anniversary Weekend
Saturday 30 & Sunday 31
January 2016

Old School Arts Centre
5 Stewart Street
10am – 3pm



Background photo: Scarf by Jean Carbon - C/BON

Explore the wide variety of
art on offer at the

RAGLAN ARTS WEEKEND

**A wonderful opportunity to
visit your favourite Raglan
artists in their studios
– or to meet new ones!**

Also new this year, visit the Old
School Arts Centre to see art from
participating artists in the Raglan
Arts Weekend 2016 Exhibition.

raglanartscentre.co.nz
📌 facebook.com/raglanart

Raglan artist locations in WIDER WHAINGAROA AREA

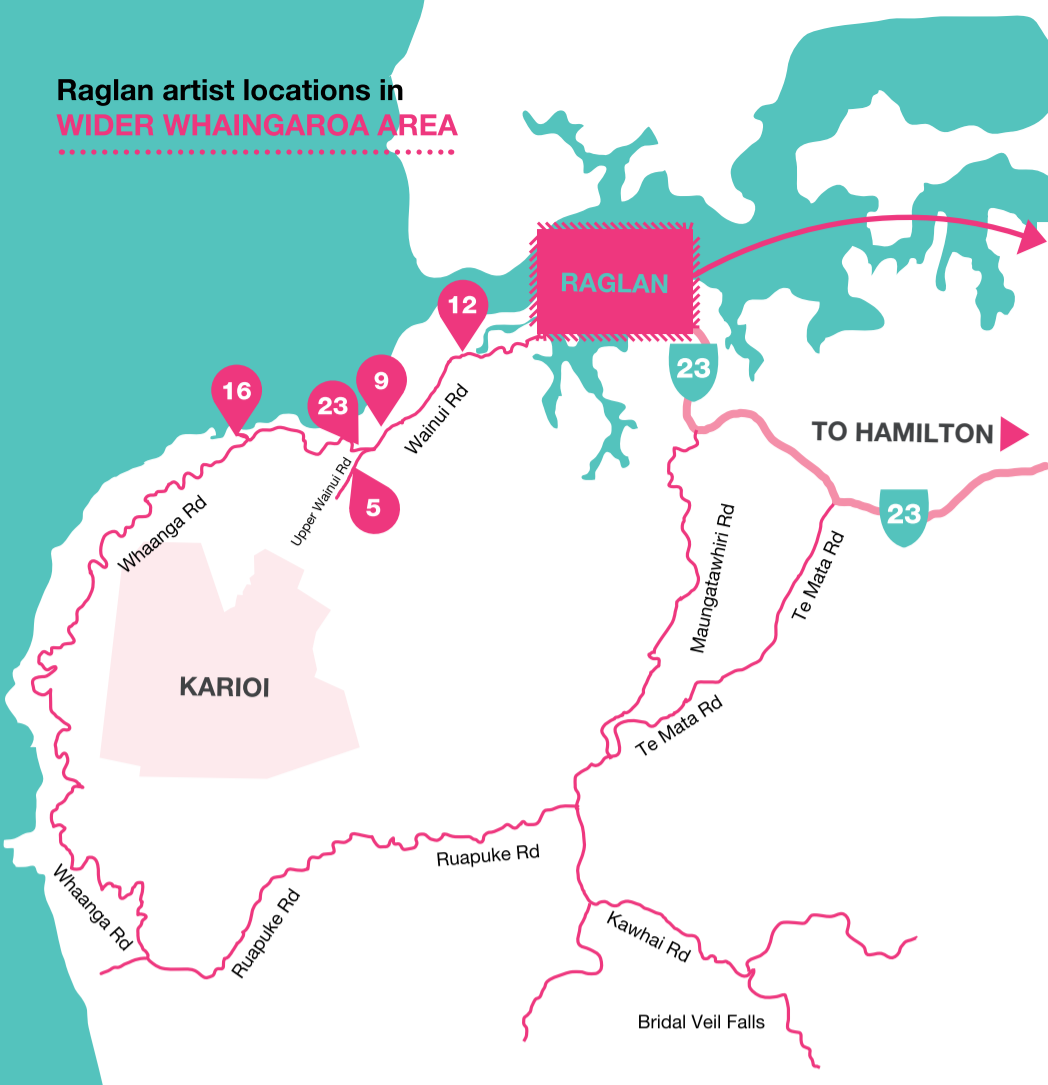

Raglan artist locations in the TOWNSHIP

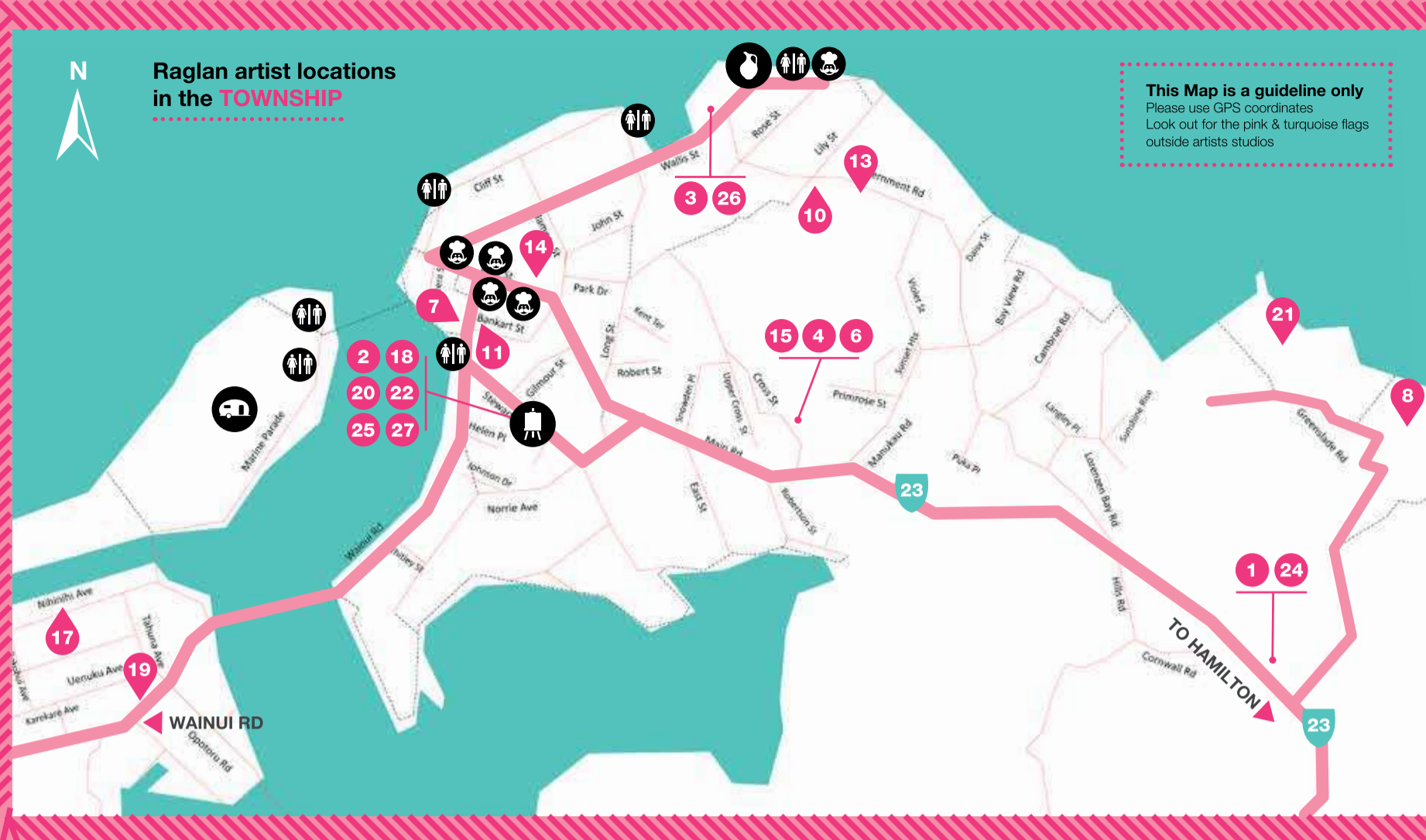

This Map is a guideline only
Please use GPS coordinates
Look out for the pink & turquoise flags
outside artists studios

1	AARON KEREOPA - 4338 Main Rd	10	JENNY RHODES - 21 Government Rd	19	RAGLAN PHOTO GALLERY - 53 Wainui Rd
2	AILENE CUTHBERTSON - Old School Arts Centre	11	JODI COLLINS - 11 Bankart St	20	RICHARD GEMMELL - Old School Arts Centre
3	BIG MONSTERS - 58 Wallis St	12	KEN THOMAS - Rock-it 248 Wainui Rd	21	RICK YOUMANS - 106B Greenslade Rd
4	CHRIS MEEK - 21 Cross St	13	LOIS BROOKS - 27 Government Rd	22	RO FAWCETT SMITH - Old School Arts Centre
5	CLAUDIA GRUTKE - 42B Upper Wainui Rd	14	MATAPIHI ART - 34 Bow St	23	SAM MATHERS - 536 Wainui Rd
6	CONTAINER LOAD - 21 Cross St	15	MEGAN HOCKLY - 21 Cross St	24	SIMON TE WHEORO - 4338 Main Rd
7	DENISE FORT - 7 Wainui Rd	16	MIRANDA CAIRD - 25A Calvert Rd, Whale Bay	25	THE CREATIVE WORKSHOP - Old School Arts Centre
8	HEARTBEADS - 78D Greenslade Rd	17	PALM PRINTS STUDIO - 23 Nihinihi Ave	26	TINA WESSLING - 58 Wallis St
9	JEAN CARBON - CBarn 492 Wainui Rd	18	RAGLAN COMMUNITY CLAY SHED - Old School Arts Centre	27	YANIV JANSON - Old School Arts Centre

ICON KEY

- OLD SCHOOL ARTS CENTRE
- TONY SLY POTTERY
- RAGLAN KOPUA HOLIDAY PARK
- PUBLIC TOILETS
- CAFES

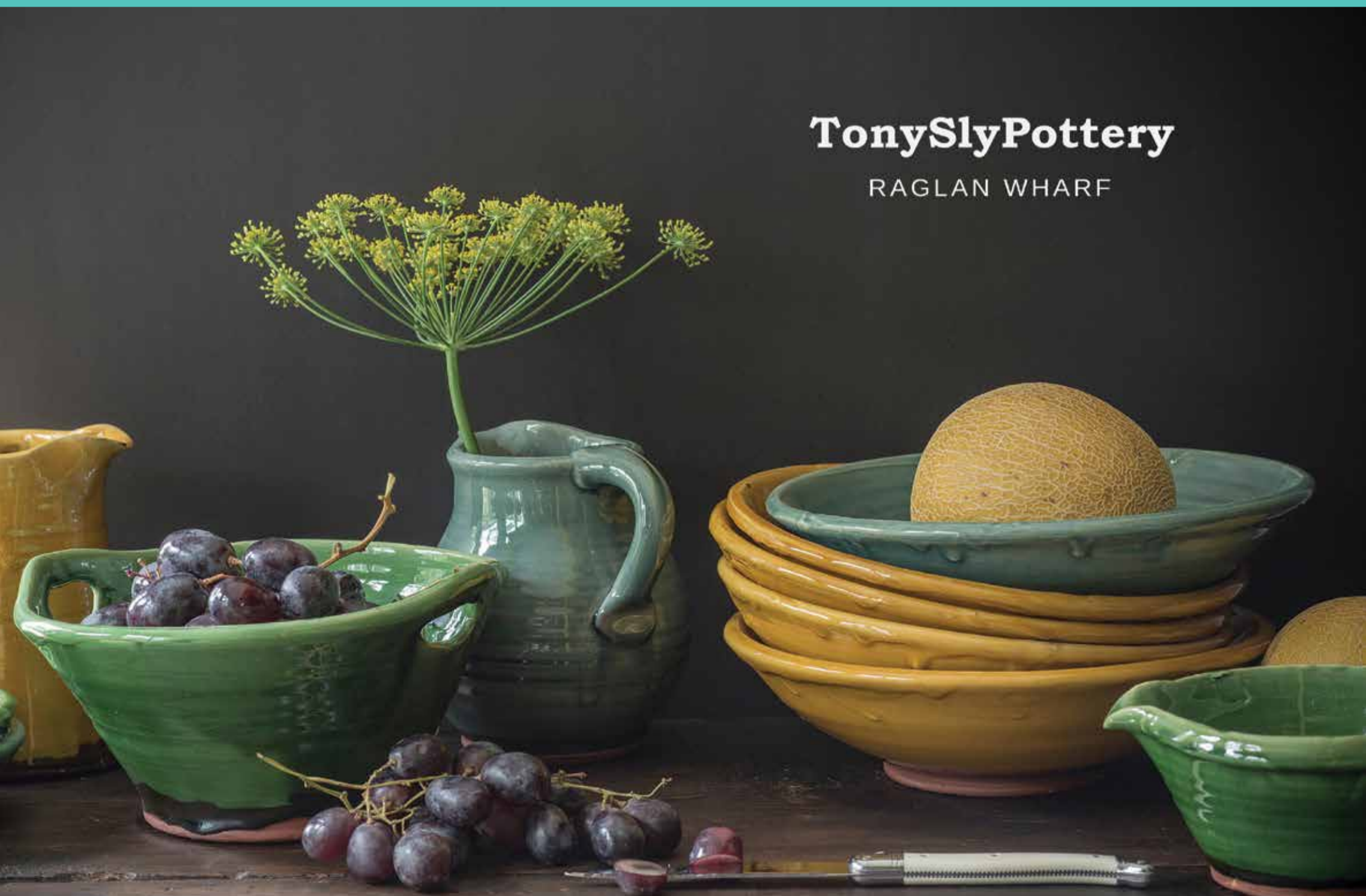

TonySlyPottery

RAGLAN WHARF

Cafés supporting Raglan Arts Weekend

- RAGLAN FISH** - Best Fish & Chips in Raglan
✉ Raglan Wharf Wallis Street
☎ 825 7544
- THE SHACK** - Serving local, honest & good food
✉ 19 Bow St
☎ 825 0027
- RAGLAN SOCIAL CLUB/ RAG BURGER** - Get Social
✉ 23 Bow St
☎ 825 8405
- BOW ST DEPOT** - Tapas Bar & Restaurant
✉ 2 Bow St
☎ 825 0976

RAGLAN KOPUA HOLIDAY PARK

A private hideaway, just 2 minutes walk to the beach, peace & tranquillity at its best.

Tents, campervans or caravans, backpackers, cabins or motel units.

Hosts: Mary and Rob Clark
Address: Marine Parade, Raglan
Phone: (07) 915 9262
Email: info@raglanholidaypark.co.nz

www.raglanholidaypark.co.nz

Show Off AOTEAROA NZ

A jewellery and fine art gallery
2 Bow Street, Raglan
ph 07 8257962